

BOTTOM VIEW

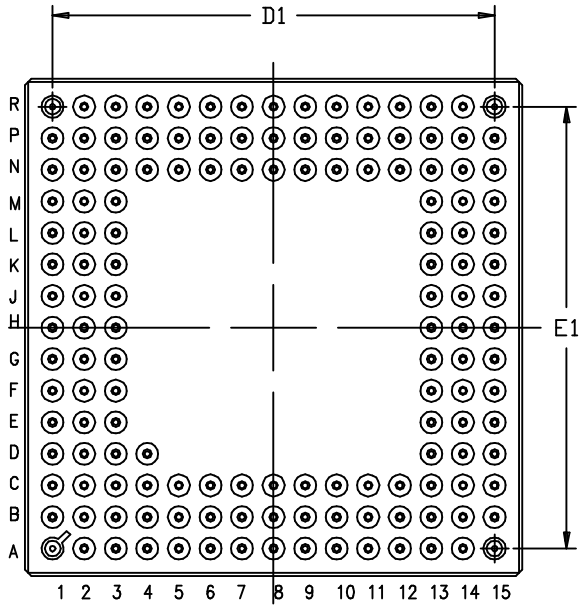

TOP VIEW

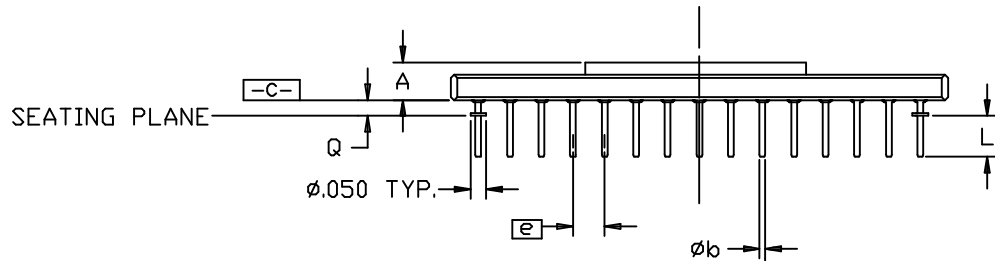
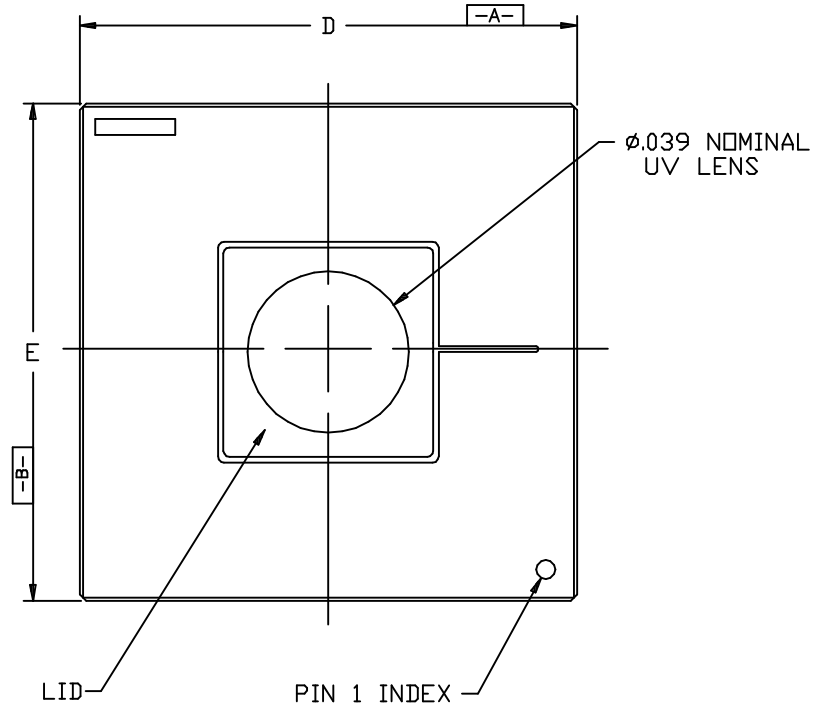

⊕	Ø.030 (M)	C	A (M)	B (M)
	Ø.010 (M)	C		

SYMBOL	INCHES			NOTE
	MIN.	NOM.	MAX.	
A	<i>xx</i>	<i>xx</i>	.145	
D/E	1.540	1.560	1.580	
D ₁ /E ₁	1.400 BSC			
L	.120	.130	.140	
Q	.050	<i>xx</i>	.060	
e	.100 BSC			
øb	.016	.018	.020	
M	15			

NOTES:

1. ALL DIMENSIONS AND TOLERANCES CONFORM TO ANSI Y14.5M-1982
2. SYMBOL "M" IS THE PIN MATRIX SIZE.
3. CONFORMS TO JEDEC MO-067-AG
4. LEAD FINISH: GOLD PLATED
 - COMMERCIAL (35 MICROINCHES MIN.)
 - MILITARY (50 MICROINCHES MIN.)

144-PIN WINDOWED PGA (PG144)