

SYMBOL	INCHES	
	MIN.	MAX.
A	\times	0.190
A1	0.015	\times
A2	0.125	0.195
B	0.014	0.022
B1	0.030	0.070
C	0.008	0.015
D	2.385	2.480
D1	0.005	\times
E	0.600	0.625
E1	0.485	0.580
e	0.100 BSC	
eA	0.600 BSC	
eB	\times	0.700
L	0.115	0.200
N	48	

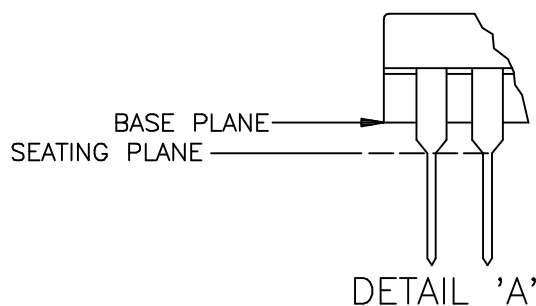

NOTES:

1. ALL DIMENSIONS AND TOLERANCES CONFORM TO ANSI Y14.5M-1982
2. "D" AND "E1" DIMENSIONS DO NOT INCLUDE MOLD FLASH OR PROTRUSIONS. MOLD FLASH or PROTRUSIONS SHALL NOT EXCEED .010".
3. LEAD FINISH: SOLDER PLATE
4. CONFORMS TO JEDEC MS-011-AD

48-PIN PLASTIC DIP (PD48)